

Technical Datasheets

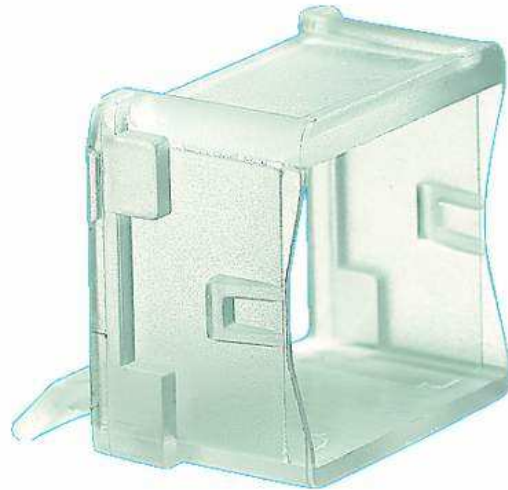

R&M Adapter Nr.1

Adapter Nr.1

Adapter Nr.1 is suitable to Avaya outlet interface.

In-House Testing after Standard:

IEC 60068-2-2: Dry warm for outlet

IEC 60068-2-1: Cold

IEC 60068-2-30: Damp heat, cyclic

In General

Material:

Polycarbonate (PC)

Colour:

Transparent

Measure

Width

16.58mm

Length

17.7mm

Depth.....

11.5mm

Technical Datas

Temperature range

-10°C to 55°C

Matching Modules

Connection Modules

Cat.5e s/u, Cat.6 s/u (Special)

R-Numbers:

R305111/ R305113/ R305112/ R305114





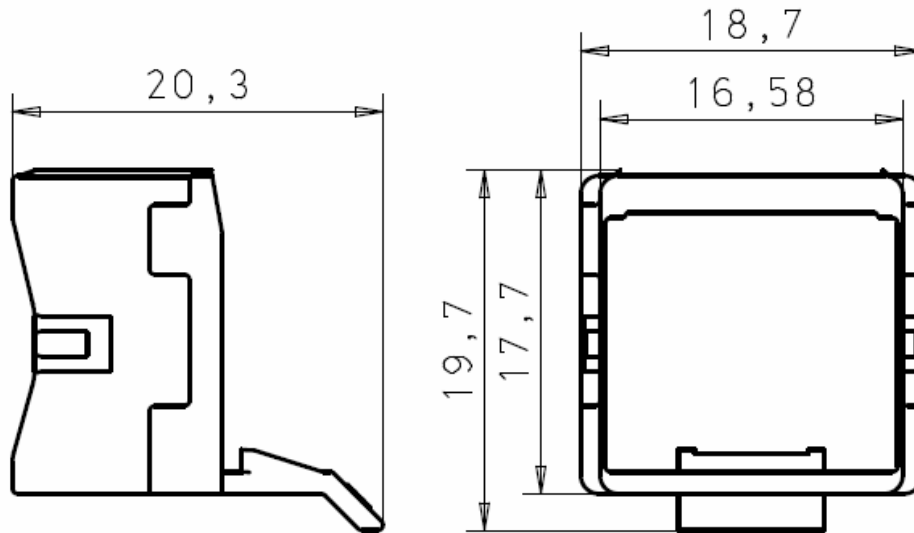

Packing

20









Dimensional Drawing

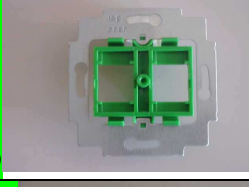

Optimal Outlet Interface

Module Holder	Mark/ Modell	Evaluation together with Outlet Interfaces	
		Unshielded	Shielded
1 	Avaya/ M10L-003	x	x
2 	Avaya/ M10LW-246	x	x
3 	Avaya/ M12AP-262	x	x
4 	Avaya/ M12L-003	x	-

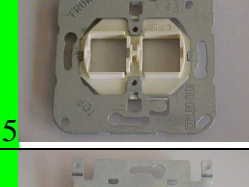
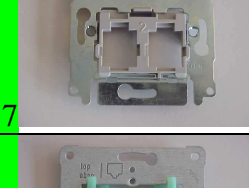
Technical Datasheets
Adapter Nr.1

5		Avaya/ M13L-246	X	X
6		Avaya/ M14L-262	X	-
7		Avaya/ M16L-246	X	-
8		Avaya/ M28L-270	X	-
9		Busch&Jäger/ 1800-2	X	X
14		Jung/	X	X
15		Jung/	X	X
17		Niko/ 77-011	X	-
18		Phena/ 80.610 MJ2 NA W	X	X

		<p>CBY Thorsman/</p>	<p>X</p>	<p>X</p>
---	--	-----------------------------------	----------	----------

Legend:

 = For both shielded and unshielded module

 = Only for unshielded module

 = Only for shielded module

 = European markets

X = Good

- = Doesn't work